

TSC Ferrite International

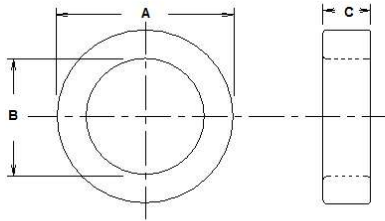

TSC FERRITE INTERNATIONAL TOROID DIMEN

PART #	A		B		C	
	in	mm	in	mm	in	mm
10-05-03	0.375	9.53	0.187	4.75	0.125	3.18
	+/-0.010	+/-0.25	+/-0.005	+/-0.13	+/-0.005	+/-0.13
10-05-06	0.375	9.53	0.187	4.75	0.250	6.35
	+/-0.010	+/-0.25	+/-0.005	+/-0.13	+/-0.005	+/-0.13
13-07-05	0.500	12.70	0.281	7.14	0.188	4.78
	+/-0.010	+/-0.25	+/-0.010	+/-0.25	+/-0.005	+/-0.13
13-07-06	0.500	12.70	0.281	7.14	0.250	6.35
	+/-0.010	+/-0.25	+/-0.010	+/-0.25	+/-0.010	+/-0.25
13-08-03	0.500	12.70	0.312	7.92	0.125	3.18
	+/-0.010	+/-0.25	+/-0.010	+/-0.25	+/-0.005	+/-0.13
13-08-06	0.500	12.70	0.312	7.92	0.250	6.35
	+/-0.010	+/-0.25	+/-0.010	+/-0.25	+/-0.010	+/-0.25
16-09-05	0.625	15.88	0.357	9.07	0.185	4.70
	+/-0.012	+/-0.25	+/-0.010	+/-0.25	+/-0.005	+/-0.13
16-09-10	0.625	15.88	0.357	9.07	0.375	9.53
	+/-0.012	+/-0.30	+/-0.010	+/-0.25	+/-0.010	+/-0.25
22-14-06	0.870	22.10	0.540	13.72	0.250	6.35
	+/-0.017	+/-0.43	+/-0.012	+/-0.30	+/-0.010	+/-0.25
22-14-07	0.870	22.10	0.540	13.72	0.275	6.99
	+/-0.017	+/-0.43	+/-0.012	+/-0.30	+/-0.010	+/-0.25
22-14-13	0.870	22.10	0.540	13.72	0.500	12.70
	+/-0.017	+/-0.43	+/-0.012	+/-0.30	+/-0.010	+/-0.25
25-16-08	1.000	25.40	0.610	15.49	0.312	7.92
	+/-0.020	+/-0.51	+/-0.015	+/-0.38	+/-0.010	+/-0.25
29-19-08	1.142	29.01	0.748	19.00	0.300	7.62
	+/-0.025	+/-0.61	+/-0.016	+/-0.41	+/-0.010	+/-0.25
29-19-15	1.142	29.01	0.748	19.00	0.600	15.24
	+/-0.025	+/-0.61	+/-0.016	+/-0.41	+/-0.010	+/-0.25
32-19-06	1.250	31.75	0.740	18.80	0.250	6.35
	+/-0.025	+/-0.64	+/-0.148	+/-0.38	+/-0.005	+/-0.13
32-19-11	1.250	31.75	0.740	18.80	0.435	11.05
	+/-0.025	+/-0.64	+/-0.148	+/-0.38	+/-0.009	+/-0.23
36-23-15	1.432	36.37	0.890	22.61	0.605	15.37
	+/-0.025	+/-0.61	+/-0.020	+/-0.51	+/-0.010	+/-0.25
37-30-16	1.469	37.31	1.168	29.67	0.625	15.88
	+/-0.029	+/-0.75	+/-0.023	+/-0.59	+/-0.013	+/-0.33
38-19-25	1.500	38.10	0.750	19.05	1.000	25.40
	+/-0.030	+/-0.76	+/-0.015	+/-0.38	+/-0.020	+/-0.51
40-24-16	1.574	39.98	0.944	23.98	0.629	15.98
	+/-0.032	+/-0.81	+/-0.019	+/-0.48	+/-0.013	+/-0.33
49-34-16	1.932	49.07	1.332	33.83	0.625	15.88
	+/-0.039	+/-0.99	+/-0.027	+/-0.69	+/-0.013	+/-0.33
51-32-19	2.000	50.80	1.250	31.75	0.750	19.05
	+/-0.040	+/-1.02	+/-0.025	+/-0.64	+/-0.015	+/-0.38

TSC Ferrite International

PART #	TSC FERRITE INTERNATIONAL TOROIDAL CORE EFFECTIVE PARAMETERS						INDUCTANCE INDEX AL nH/N ²				
	MAGNETIC PATH LENGTH	EFFECTIVE CORE AREA	EFFECTIVE CORE VOLUME	WINDOW AREA	POWER HANDLING CAPABILITY INDEX	CORE WEIGHT	ASTM Material Type				
	Le cm	Ae cm ²	Ve cm ³	Wa cm ²	WaAe cm ⁴	GRAMS	ASTM P7099 ASTM P5099	ASTM P7070	ASTM P8040 ASTM F3000 P5025-100	ASTM F5000	ASTM F010K
							TSC Ferrite Material Grade				
							TSF-BOOST TSF-7099 TSF-5099 +30%	TSF-7070 +25%	TSF-8040 TSF-50ALL Flat Line +25%	TSF-5000 +25%	TSF-010K +30%
10-05-03	2.07	0.07	0.15	0.18	0.01	0.8	885	972	1,370	2,209	4,390
10-05-06	2.07	0.15	0.30	0.18	0.03	1.6	1,765	1,944	2,740	4,419	6,615
13-07-05	2.95	0.13	0.38	0.40	0.05	2.0	1,100	1,210	1,706	2,752	5,430
13-07-06	2.95	0.17	0.51	0.40	0.07	2.6	1,465	1,610	2,269	3,659	7,225
13-08-03	3.12	0.07	0.23	0.49	0.04	1.2	600	659	928	1,497	2,975
13-08-06	3.13	0.15	0.47	0.49	0.07	2.4	1,200	1,318	1,857	2,995	5,935
16-09-05	3.72	0.16	0.58	0.65	0.10	3.0	1,050	1,158	1,632	2,632	5,520
16-09-10	3.72	0.32	1.18	0.65	0.20	6.1	2,130	2,347	3,307	5,334	11,040
22-14-06	5.42	0.26	1.42	1.48	0.39	7.2	1,210	1,333	1,878	3,029	6,040
22-14-07	5.42	0.29	1.56	1.48	0.42	7.9	1,330	1,466	2,065	3,331	6,645
22-14-13	5.42	0.52	2.83	1.48	0.77	14.4	2,420	2,665	3,755	6,057	12,080
25-16-08	6.17	0.39	2.37	1.89	0.73	12.1	1,565	1,724	2,429	3,917	7,825
29-19-08	7.32	0.38	2.75	2.84	1.07	13.8	1,290	1,419	1,999	3,224	6,340
29-19-15	7.32	0.75	5.50	2.84	2.13	27.8	2,580	2,837	3,998	6,447	12,895
32-19-06	7.59	0.40	3.05	2.78	1.12	15.7	1,330	1,465	2,064	3,329	6,105
32-19-11	7.59	0.70	5.31	2.78	1.84	27.3	2,315	2,549	3,591	5,793	11,580
36-23-15	8.92	1.04	9.26	4.01	4.17	47.0	2,925	3,216	4,531	7,309	13,400
37-30-16	10.43	0.60	6.30	6.91	4.18	30.6	1,455	1,602	2,257	3,640	7,280
38-19-25	8.30	2.32	19.29	2.85	6.61	104.9	7,045	7,750	10,915	17,600	35,210
40-24-16	9.62	1.25	12.04	4.52	5.65	61.6	3,270	3,595	5,064	8,168	16,330
49-34-16	12.73	1.20	15.22	8.99	10.79	75.6	2,365	2,600	3,660	5,900	11,805
51-32-19	12.50	1.78	22.27	7.92	14.10	112.9	3,580	3,940	5,551	8,954	17,900