

**MAIN ILLUSTRATION**

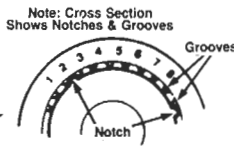

**5. INSERTING THE SCREWS**

Select the desired screw and push the head of the screw down into the opening of the POWERDRIVER, pushing the head of the screw below the ball bearings. (See illus. 5) As you gain more experience and comfort with the POWERDRIVER, you will actually be able to pop them in in seconds and go right to work. When you first use the POWERDRIVER, you may want to turn the screw slightly until you feel the bit go into the head of the screw before turning on the drill. To remove the screw from the POWERDRIVER, push Inner Sleeve down and with fingers or long nose pliers, remove the screw.

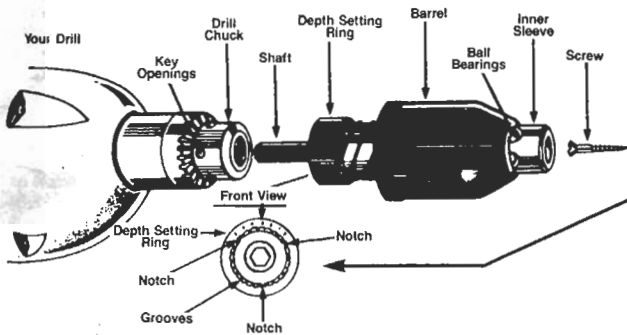
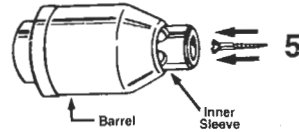

**OPERATION INSTRUCTIONS FOR THE MULTI-PIECE POWERDRIVER SET**

You have just purchased a complete power driving system that you may consider to be one of your finest investment in tools. With the POWERDRIVER, you will be able to drive a great variety of screws into just about any surface so easily and effectively that you may never want to use a screwdriver again. Just be sure to read these instructions carefully and use a piece of scrap wood to practice. Like many other new tools, the POWERDRIVER requires some practice to master. The POWERDRIVER works on drills as small as 1/4". However, some 1/4" drills don't open up to a full 1/4". If this is the case and the shaft of the POWERDRIVER will not fit into the chuck once it is completely opened, you may purchase an adapter available at most hardware stores.

**1. POWERDRIVER INSTALLATION**

The POWERDRIVER is mounted onto your drill the same way you insert any ordinary drill bit or power tool accessory. (See illus. 1) Insert shaft of POWERDRIVER into open chuck. (See illus. 1A) Then tighten chuck properly using the chuck key.

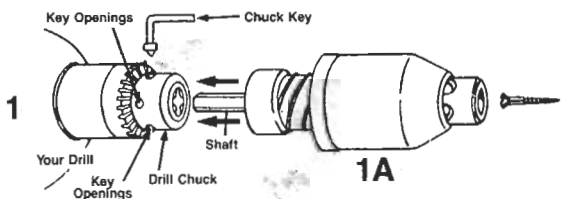

**2. INSERTING/CHANGING THE BIT**

Your POWERDRIVER comes with a Phillips, a Robertson and a Slot bit. Select the desired bit and push the barrel end of the bit (the end with the black rubber ring) down into the Inner Sleeve. (See illus. 2) Push it so that the bit goes below the four ball bearings. You may want to use a pair of needle nose pliers to push the bit into place. Remember the entire bit should be completely below the four silver ball bearings. If bit does not appear to be firmly in place, hold the barrel of the POWERDRIVER and press the trigger of your drill on and off for a few seconds. This will cause the bit to drop into place. TO REMOVE OR CHANGE BIT, push Inner Sleeve down and with fingers or needle nose pliers, remove bit. (See illus. 2B)

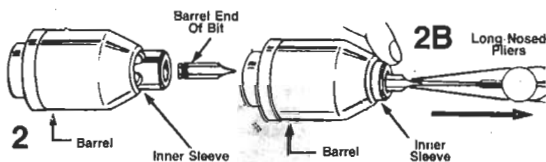

**3. SELECTING THE RIGHT SCREWS**

We suggest you use screws that are one inch or greater in length. For least amount of slippage we recommend using Phillips screws that range in size from #6 - #12. Slot screws should range in size from #10 - #12 and Robertson from #8 - #10. Long or thick screws, round head or flat, present no problem for the POWERDRIVER.

**4. OPERATION OF DEPTH SETTING RING**

Near the shaft of your POWERDRIVER, you will find the Depth Setting Ring. Push this ring forward towards Inner Sleeve of your POWERDRIVER. You will notice a silver cylinder underneath the ring with 3 small notches on it. (See illus. 3) On the inside of Depth Setting Ring you will see grooves. (See illus. 4) Eight of the grooves have numbers on them from 1 and 8. By pushing the Depth Setting Ring towards the Inner Sleeve and rotating it, you can place the notch into any of the settings from 1 to 8. That is your depth setting. It makes no difference which of the 3 notches you set into the numbered groove.

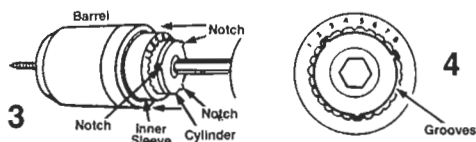

**6. USING THE POWERDRIVER**

Now you are ready to go to work! Place the tip of the screw against the surface you are going to work on. If using a drill with reversible switch make sure drill is in forward for driving screws in and in reverse for removing them. Only assert very light pressure on the drill. Operate the drill on its lowest speed if you have a variable speed drill. Press the trigger and apply short bursts to firmly place screw into material you are working on. You will feel the screw grip the material. It is not necessary to give full power. The POWERDRIVER will drive the screw into the surface and release it at the preset depth. If the screw does not go to the proper depth it means that you may have let the bit slip. Just stop the drill and with the shaft of the POWERDRIVER, you will feel the bit catch the head of the screw. Press the trigger and continue. When the screw is in place the POWERDRIVER will release the screw and you are ready for the next screw. After a little bit of practice you will find the POWERDRIVER extremely easy to use.

**7. REMOVING SCREWS**

MAKE SURE DRILL IS IN REVERSE SETTING. To remove the screw use setting number eight. (See section on using DEPTH SETTING RING) Press back Inner Sleeve so that you can see the tip of the bit. Place the tip of the bit into the head of the screw and assert slight pressure on the drill. Then press the drill trigger. This will remove the screw. Remember not to lift the drill until the screw is completely out as this slight pressure is needed to keep the bit in contact with the head of the screw.

**SOME TIPS ON USING THE POWERDRIVER**

Always use the slowest speed possible if you have a variable speed drill. If you have the choice, we recommend a variable speed reversible drill. Although this is not necessary, it gives you increased flexibility and performance.

PRACTICE! As with any other new tool, you should get the feel of it on scrap material. It does take some practice before you become an expert with the POWERDRIVER. It's easy as soon as you get the hang of it and you may never want to use an ordinary screwdriver again.

IF IT JAMS. Gently tap the unit and it will free up. Don't force it. If you have it stuck on a screw with the screw part way into the surface and you want to remove the POWERDRIVER, just push back the Inner Sleeve and this will free your screw. Even though you can go into some concrete and cinder block without using a pilot hole, we suggest that you first test to see if a pilot hole is needed. USE GOOD QUALITY SCREWS... they hold better. If you have the choice, use PHILLIPS or ROBERTSON screws for a better grip.

**NAILDRIVER™**

Primarily for the use of finishing nails and other nails with heads small enough to fit inside the shaft of the NAILDRIVER. To load the NAILDRIVER, insert the nail, head first, down into the shaft of the NAILDRIVER. (See illus. 6) If you are working with a small finishing nail, the nail will completely disappear inside the shaft. This is fine. There is a small magnet inside the shaft which will hold the nail in place. This enables you to turn the NAILDRIVER upside down. Place the shoe-shaped portion of the NAILDRIVER in the palm of your hand. Extend your index finger and thumb along the neck of the NAILDRIVER and wrap your remaining fingers around the rounded portion of the NAILDRIVER. (See illus. 7) Place opening of the shaft against the surface you wish to nail. (See illus. 8) Using the strength of your arm, exert pressure in the direction you wish to drive the nail in. The shaft is spring loaded and retracts when pressure is put on the NAILDRIVER. The amount of pressure you use can be determined with practice. With larger nails and a harder surface, NAILDRIVER can still save you from smashing your thumb. Use it to start the nail, the most difficult part, and finishing off as you normally would with a hammer. The difference? Your thumb is still in one piece and you may not have damaged the wall as you would have the old fashioned way. PLEASE BE CAREFUL WHEN HANDLING THE NAILDRIVER NOT TO PUSH THE SHAFT DOWN WITH YOUR THUMB. IF THE NAILDRIVER IS LOADED AND YOU'RE NOT AWARE OF IT A SLIGHT AMOUNT OF PRESSURE CAN CAUSE A NAIL TO GO INTO YOUR THUMB.

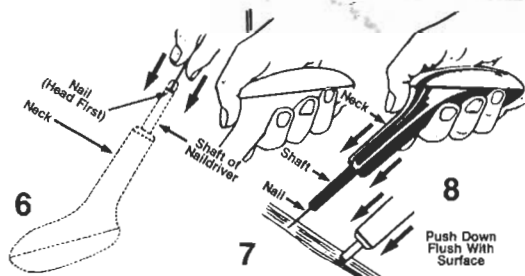

**TO PURCHASE ADDITIONAL BITS FOR YOUR POWERDRIVER**

If Additional bits are required, kindly send \$5.00 (handling and postage included) for a set which includes 1 Slot, 1 Phillips and 1 Robertson bit. Please indicate how many sets when ordering. Send cheque or money order to: The Home Shoppe Limited, 56 Bramstele Road, Unit 8, Brampton, Ontario L6W 3N4.

**WHICH SETTING TO USE.** The lower the number of the setting, the more raised the screw will be and the higher the number of the setting the deeper the screw will be. If you are working with a fragile surface and you want to leave the screw raised for any reason, you would use a low setting like "1" or "2". If you want the screw in deep or countersunk, you would use a high number such as "7" or "8". The exact setting can best be determined for any particular screw by practicing on a piece of scrap material before you actually do the job.

**10 YEAR LIMITED WARRANTY**

This product is warranted against defects in material and workmanship for a period of 10 years from date of purchase. The obligation under this warranty is limited to repairing or replacing any defective part and providing all necessary labor in connection with the correction of any defect for 10 years from date of purchase. If it fails within the warranty period, it will be repaired upon receipt of handling charge. This warranty is void if the product has been damaged by accident, abuse, use other than indicated in the instructions, shock, fall, or neglect. It does not apply to production related work. This warranty extends only to the original purchaser and is not transferable.

Repair or replacement is provided under this warranty is the exclusive remedy of the consumer. All implied warranties are expressly excluded and The Home Shoppe shall not be liable for loss of product use or other incidental or consequential costs incurred by the purchaser.

Liability is the repair of the item. To be serviced under warranty, send the item together with \$5.00 to cover the cost of processing, postage and handling. Send the damaged part only. Fill in the form and enclose it when you return the product.

Send to: The Home Shoppe Limited, 56 Bramstele Road, Unit 8, Brampton, Ontario L6W 3N4

Purchase Date \_\_\_\_\_  
 Name \_\_\_\_\_  
 Address \_\_\_\_\_  
 City \_\_\_\_\_ Province \_\_\_\_\_ Postal Code \_\_\_\_\_  
 Purchased from \_\_\_\_\_